

NEW JERSEY DEPARTMENT OF THE TREASURY
 DIVISION OF TAXATION
 LOCAL PROPERTY AND PUBLIC UTILITY TAX BUREAU
 APPROVED AS A TAX MAP PURSUANT TO THE
 PROVISIONS OF CHAPTER 175, LAWS OF 1913, ETC.
 FOR THE DIRECTOR, DIVISION OF TAXATION
 BY *J. N. O'Donnell* P.E. & L.S.
 LIC. # 15434 MANAGER, ANALYSIS SECTION
 DATE JUL 8 1972 SERIAL NO. 7414

BOROUGH OF HOHOKUS

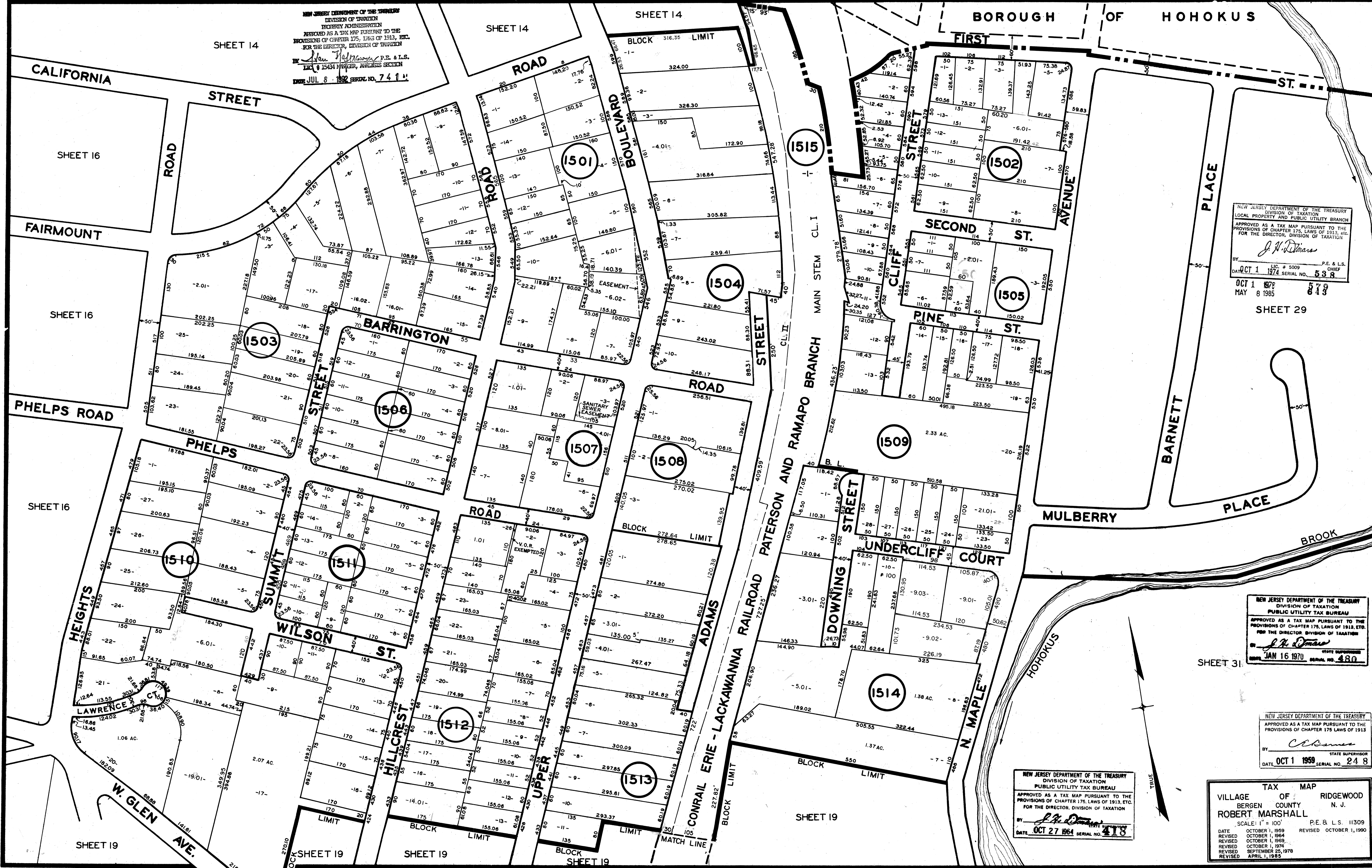

NEW JERSEY DEPARTMENT OF THE TREASURY
 DIVISION OF TAXATION
 LOCAL PROPERTY AND PUBLIC UTILITY TAX BUREAU
 APPROVED AS A TAX MAP PURSUANT TO THE
 PROVISIONS OF CHAPTER 175, LAWS OF 1913, ETC.
 FOR THE DIRECTOR, DIVISION OF TAXATION
 BY *J. N. O'Donnell* P.E. & L.S.
 LIC. # 5009 CHIEF
 DATE OCT 1 1974 SERIAL NO. 538
 MAY 8 1985 848

SHEET 29

NEW JERSEY DEPARTMENT OF THE TREASURY
 DIVISION OF TAXATION
 PUBLIC UTILITY TAX BUREAU
 APPROVED AS A TAX MAP PURSUANT TO THE
 PROVISIONS OF CHAPTER 175, LAWS OF 1913, ETC.
 FOR THE DIRECTOR, DIVISION OF TAXATION
 BY *J. N. O'Donnell* P.E. & L.S.
 LIC. # 15434 MANAGER, ANALYSIS SECTION
 DATE JAN 16 1970 SERIAL NO. 480

SHEET 31

NEW JERSEY DEPARTMENT OF THE TREASURY
 DIVISION OF TAXATION
 PUBLIC UTILITY TAX BUREAU
 APPROVED AS A TAX MAP PURSUANT TO THE
 PROVISIONS OF CHAPTER 175, LAWS OF 1913, ETC.
 FOR THE DIRECTOR, DIVISION OF TAXATION
 BY *J. N. O'Donnell* P.E. & L.S.
 LIC. # 15434 MANAGER, ANALYSIS SECTION
 DATE OCT 27 1964 SERIAL NO. 418

VILLAGE OF RIDGEWOOD
 BERGEN COUNTY N. J.
 ROBERT MARSHALL
 SCALE: 1" = 100' P.E. & L.S. 11309
 DATE OCTOBER 1, 1969 REVISED OCTOBER 1, 1990
 REVISED OCTOBER 1, 1964
 REVISED OCTOBER 1, 1969
 REVISED OCTOBER 1, 1974
 REVISED SEPTEMBER 25, 1978
 REVISED APRIL 1, 1982