

NEW JERSEY DEPARTMENT OF THE TREASURY
 DIVISION OF TAXATION
 PROPERTY ADMINISTRATION
 APPROVED AS A TAX MAP PURSUANT TO THE
 PROVISIONS OF CHAPTER 175, LAWS OF 1913, ETC.
 FOR THE DIRECTOR, DIVISION OF TAXATION
J. H. Thomas
 LIC. # 15434 INSURER, ANALYST
 JUL 8 1992 SERIAL NO. 741

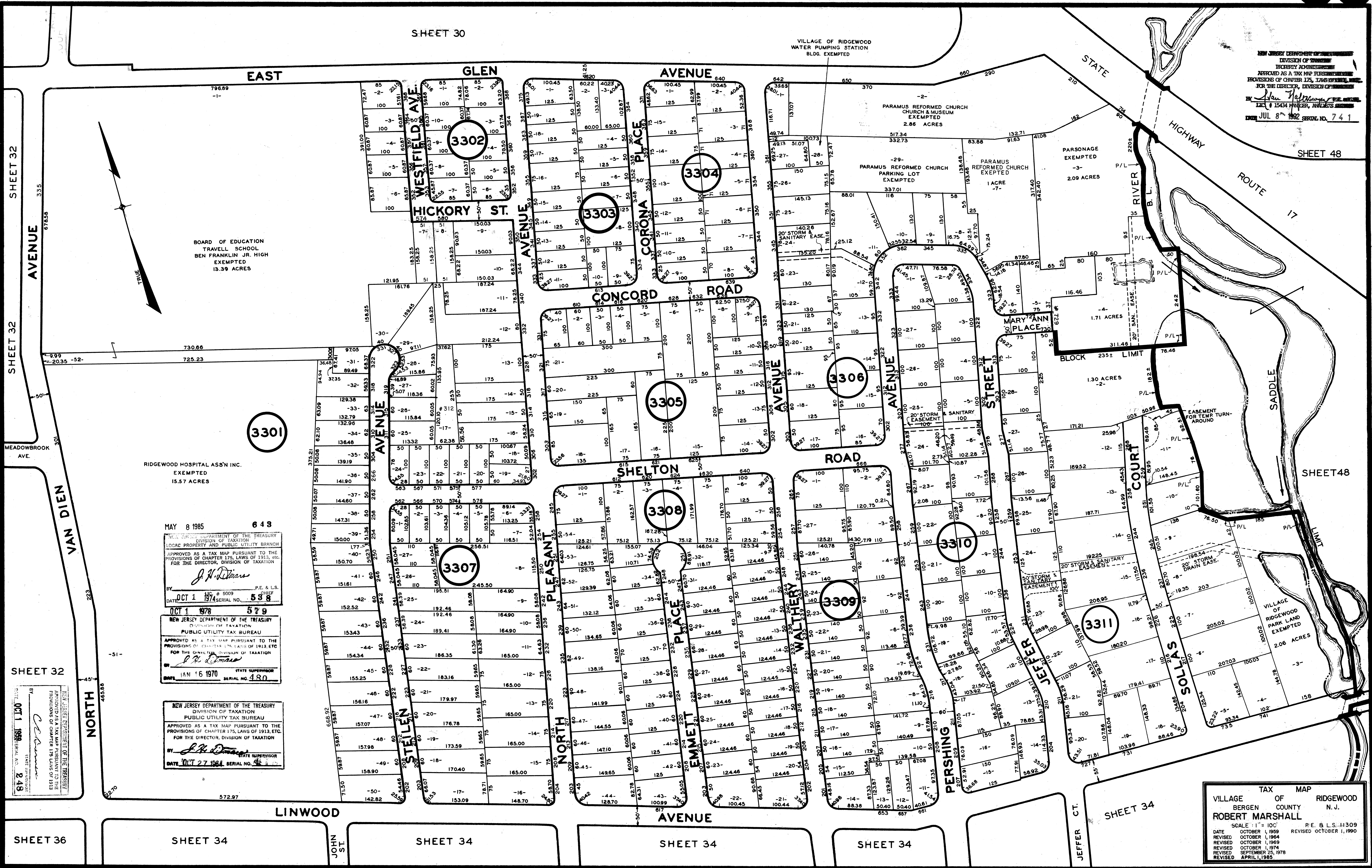

SHEET 32

SHEET 48

SHEET 48

SHEET 32

SHEET 36

SHEET 34

SHEET 34

SHEET 34

SHEET 34

SHEET 34

MAY 8 1985 643
 NEW JERSEY DEPARTMENT OF THE TREASURY
 DIVISION OF TAXATION
 LOCAL PROPERTY AND PUBLIC UTILITY BRANCH
 APPROVED AS A TAX MAP PURSUANT TO THE
 PROVISIONS OF CHAPTER 175, LAWS OF 1913, ETC.
 FOR THE DIRECTOR, DIVISION OF TAXATION
J. H. Thomas
 LIC. # 15434
 OCT 1 1974 SERIAL NO. 538

OCT 1 1978 579
 NEW JERSEY DEPARTMENT OF THE TREASURY
 DIVISION OF TAXATION
 PUBLIC UTILITY TAX BUREAU
 APPROVED AS A TAX MAP PURSUANT TO THE
 PROVISIONS OF CHAPTER 175, LAWS OF 1913, ETC.
 FOR THE DIRECTOR, DIVISION OF TAXATION
J. H. Thomas
 LIC. # 15434
 JAN 16 1970 STATE SUPERVISOR
 SERIAL NO. 480

NEW JERSEY DEPARTMENT OF THE TREASURY
 DIVISION OF TAXATION
 PUBLIC UTILITY TAX BUREAU
 APPROVED AS A TAX MAP PURSUANT TO THE
 PROVISIONS OF CHAPTER 175, LAWS OF 1913, ETC.
 FOR THE DIRECTOR, DIVISION OF TAXATION
J. H. Thomas
 LIC. # 15434
 DATE: OCT 27 1984 SERIAL NO. 480

TAX MAP
 VILLAGE OF RIDGEWOOD
 BERGEN COUNTY N.J.
 ROBERT MARSHALL
 SCALE: 1" = 100'
 DATE: OCTOBER 1, 1969 P.E. & L.S. #1309
 REVISED: OCTOBER 1, 1964 REVISOR: OCTOBER 1, 1969
 REVISED: OCTOBER 1, 1969 REVISOR: OCTOBER 1, 1969
 REVISED: OCTOBER 1, 1974 REVISOR: OCTOBER 1, 1974
 REVISED: SEPTEMBER 25, 1978 REVISOR: SEPTEMBER 25, 1978
 REVISED: APRIL 1, 1985 REVISOR: APRIL 1, 1985